

Brother Continues to Drive a New Era of Product Excellence and Industry Change

Since its inception in 1908, Brother has been at the forefront of product innovation, dedicated to delivering superior and innovative sewing technology to our customers.

While these innovative changes have now become the industry standard, our never-ending spirit of challenge and innovation inherited from our ancestors have helped us surmount many challenges in the marketplace and continue striving for product excellence.

It is with this spirit of pride and dedication that we introduce our new line of NEXIO industrial sewing machines.

This new brand name is derived from the words "Next" and "Society," combining our vision to drive a new era of industry change with continual dedication to innovative product development, as well as our continued company commitment to forging strong customer relationships by being "At your side."

Specifications/

BAS-311HX-0 ■ ■ ■ BAS-326HX-0 ■ ■ A BAS-341HX-05A BAS-342HX-05A

	BAS-311HX	BAS-326HX	BAS-341HX	BAS-342HX
Stitch form	Single needle lock stitch			
Max. sewing speed	2,800st/min*1			
Max. sewing area	150 x 100mm	220 x 100mm	250 x 160mm	300 x 200mm
Feed mechanism	Intermittent feed(pulse motor drive)			
Stitch length	0.05-12.7mm(per 0.05mm)			
Max. number of stitches	20,000 stitches (per program)			
Max. number of programs	999			
Work clamp drive	-S:Pulse motor drive -A:Pneumatic drive	Pneumatic drive		
Work clamp lift amount	-S:Max. 25mm -A:Max.30mm	Max.30mm		
2-step work clamp	-S:Integrated-type work clamp -A:Separate-type work clamp	Separate work clamp	Unit work clamp	
Height of stepping presser foot	22mm			
Stepping presser foot stroke	2-4.5mm, 4.5mm-10mm or 0(Default setting: 3mm)			
Hook	Double-capacity shuttle hook			
Thread wiper	Standard equipment			
Thread trimmer	Standard equipment			
Digital tension	Standard equipment			
Thread breakage detector	Standard equipment			
Data storage media	Internal flash memory(Data addition is available with external memory)			
Motor	AC servo motor 550W			
Weight	Machine head:Approx.88kg Control box:Approx.9kg	Machine head:Approx.166kg Control box:Approx.18kg	Machine head:Approx.174kg Control box:Approx.18kg	
Power	Single phase 100V/200V 3-phase 200V/220V/380V/400V	Single phase 220V 3-phase 200V/220V/380V/400V		
Air pressure /Consumption	0.5MPa 1.8 l/min			

Optional parts/

- *Needle cooler-<SA559101>*2
- *Inner clamping device(BAS-311HX/326HX only)-<SA7189101>*2
- *Automatic ejector(BAS-341HX/342HX only)-<SA9147001>
- *2-step thread tension device-<SA7197101>
- *Option manifold 5 set-<SA7500001>
- *Optional solenoid valve set-<SA7171001>

Peripheral equipment/

- *Sewing data programming software PS-300B



*1 The stitch length is 4mm or below (BAS-311HX/326HX) , 3.5mm or below(BAS-341HX/342HX).
*2 This device requires the option manifold 5 set and optional solenoid valve set.

Facebook



RoHS Compliant

BAS-311HX/326HX/341HX/342HX is compliant with the RoHS Directive(the restriction of the use of certain hazardous substances in electrical and electronic equipment) which came into effect in the EU in July 2006.



Brother has established voluntary environmental standards for products and created the "Brother Green Label". BAS-311HX/326HX/341HX/342HX is certified as an environment-conscious sewing machine according to the "Brother Green Label" standard.



Working with you for a better environment
www.brotherearth.com

HN Office: Room 601, 6th Floor, Van Hoa Build, 51 Kim Ma Street
Kim Ma Ward, Ba Dinh District, Ha Noi, Viet Nam

Tel: (+84) 24 3732 6374

HCM Office: 43 Tran Khanh Du, Tan Dinh Ward, District 1,
Ho Chi Minh City, Viet Nam

Tel: (+84) 28 3526 0082
(+84) 28 3526 0084



English website

brother BROTHER INTERNATIONAL (VIETNAM) CO., LTD.

2021.01 10091508B Vol.4

brother
at your side

BAS-311HX
150mm x 100mm

BAS-326HX
220mm x 100mm

BAS-341HX
250mm x 160mm

BAS-342HX
300mm x 200mm

Direct Drive Programmable Electronic Pattern Sewer with Cylinder Bed

The machines provide the highest quality sewing exactly the way it is programmed even at high speed sewing with maximum performance according to each sewing area.

With the high functional LCD touch panel that offers easy programming, the preparation time can be reduced.



NEXIO

NEXIO

Superior Quality and High Speed

The machines provide the highest quality sewing exactly the way it is programmed even at high speed sewing with maximum performance according to each sewing area. With the high functional LCD touch panel that offers easy programming, the preparation time can be reduced.



B

1 World's Top-class Sewing Speed of 2,800sti/min with High Quality Sewing

Higher rigid feed mechanism was adopted while achieving the world's top-class sewing speed of 2,800sti/min. With its accurate stitch point, the machine can perform beautiful stitching with stable thread tightening.

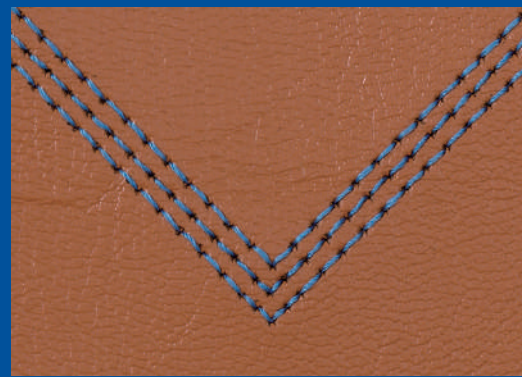

Sewing speed: 2,800sti/min, stitch length: 4mm

2 New Digital Tension Allows for a Wide Variety of Threads

Various sizes of sewing threads can be used by the new digital tension which increases the setting range of the upper thread tension by 1.7 times compared to conventional machines.

3 Reduction of Disposition of Thread Ends

Renewed thread trimmer cuts the thread, realizing short remaining threads. The disposition of thread ends after sewing will be able to reduced.

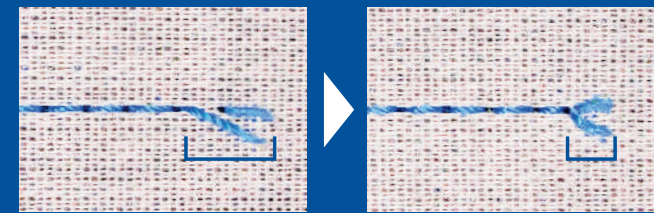

Conventional Model

BAS-342HX

4 Great Needle Penetration

Powerful motor(550W) outputs large amounts of torque even at slow speeds so that strong needle penetration force can be obtained. If the needle penetration resistance increases, vibration control(intermittent impact) automatically increases the penetration force.

5 High Energy Saving

This machine is the most energy-saving programmable electronic pattern sewing machine among in its class, while realizing high-speed sewing and strong needle penetration force.

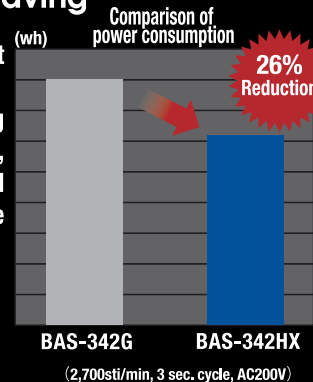

6 Uniform and Stable Thread Tightness

It realized stable thread tightening at low tension sewing. Excessive or insufficient pressing by the stepping foot can be prevented, enabling a finish with uniform thread tightening.



7 Easy Replacement of Presser and Feed Plate

The work clamp can be replaced quickly by loosening the two screws(BAS-311HX/326HX), and four screws (BAS-341HX/342HX). When replacing the feed plate, align the reference holes of the needle plate and the feed plate.

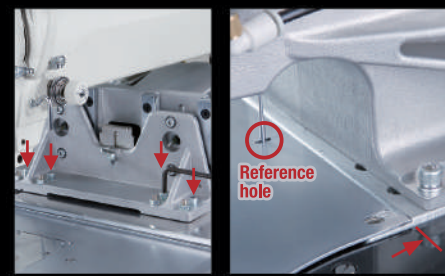

Reference hole

A Best User Experience with LCD Touch Panel

7-inch large screen and easy programming functions via LCD touch panel enable an intuitive operation. It is easily understood without the instruction manual or previous experience in fewer steps.

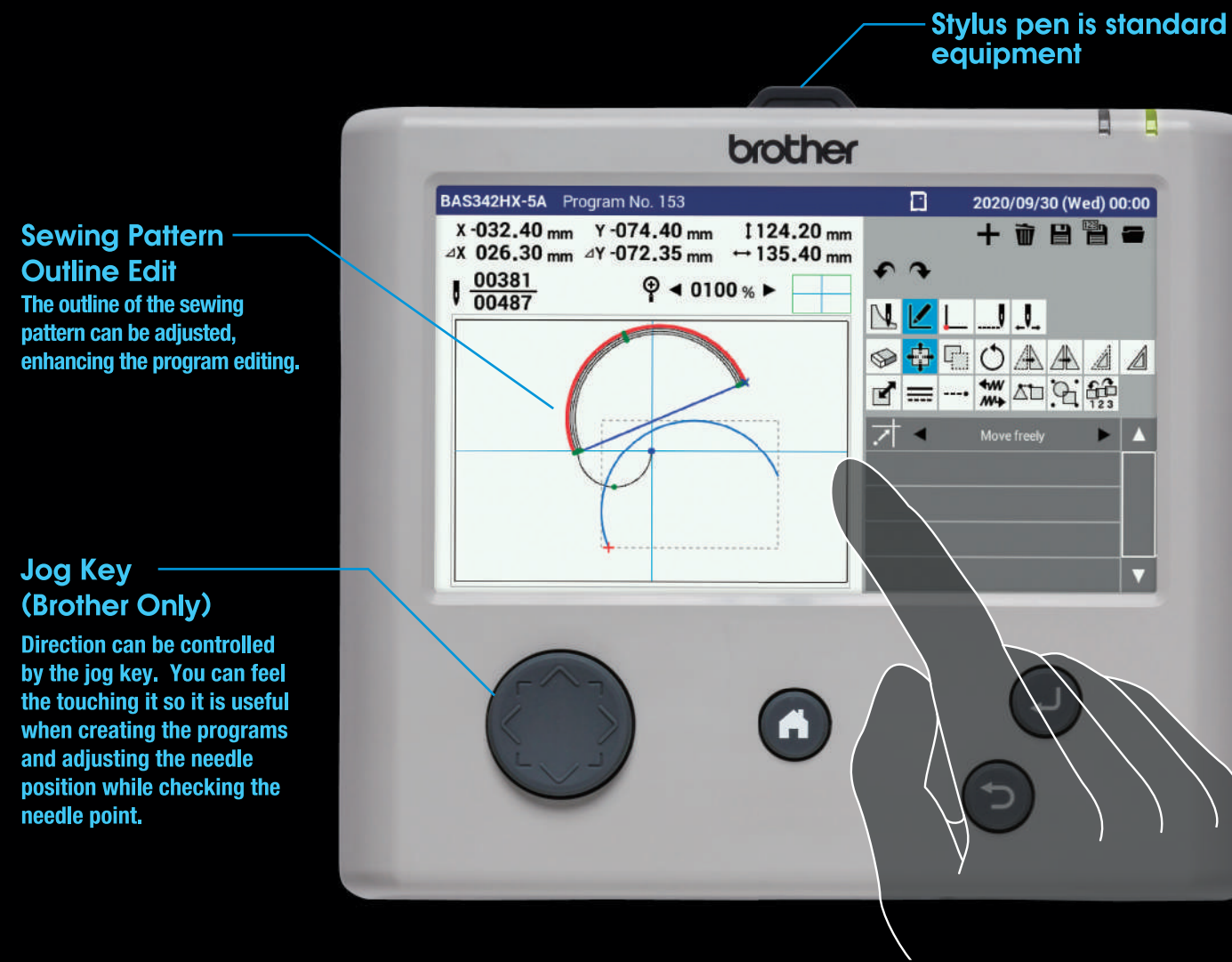

Sewing Pattern Outline Edit
The outline of the sewing pattern can be adjusted, enhancing the program editing.

Jog Key (Brother Only)
Direction can be controlled by the jog key. You can feel the touching it so it is useful when creating the programs and adjusting the needle position while checking the needle point.

Stylus pen is standard equipment

Program Creating

Program creation can be available easily with illustration icons.

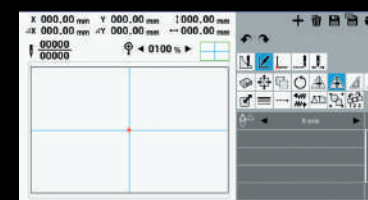

File Selection

The preview of the program can be seen on the panel.



Program Selection

The information regarding the program is seen at one screen. The setting change is available on it.

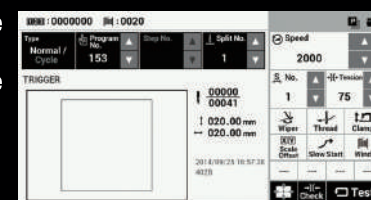

Manual Display

The mistakable preparations such as Threading the upper thread, Winding the lower thread can be checked on the panel.

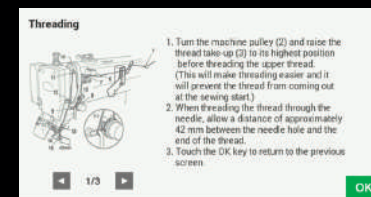

Multimedia Support

Supporting the SD card (1 slot), USB port (2 ports). An expansion port is also supported, enabling to connect with a bar code reader etc.



Compliant with VESA Standards (Brother Only)

The LCD touch panel is compliant with the VESA standards, enabling to attach to any articulating monitor arm.



*VESA Standard is international mounting interface standard.
*Please purchase commercially available monitor arms.

Memory Switch Settings

The detail of Memory switch settings can be checked on the panel without the manuals.

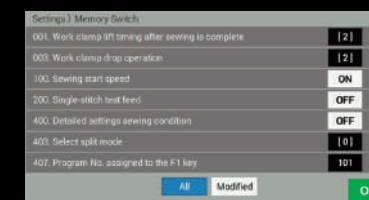

Error Message Display

When an error occurs, the error message and solution are displayed on the panel, helping reduce the downtime.

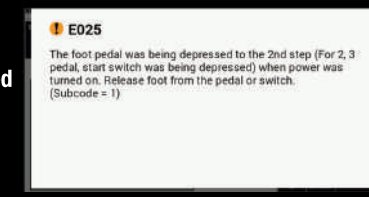

B BAS lineups for your various types of sewing applications



BAS-311HX
220mm x 100mm



BAS-326HX
220mm x 100mm

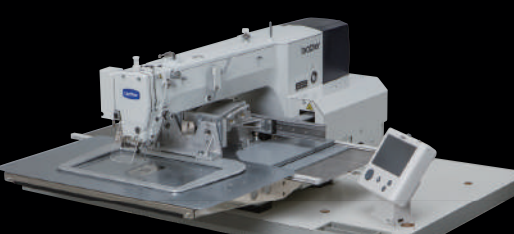

BAS-341HX
250mm x 160mm



BAS-342HX
300mm x 200mm

